

How to Administer Intranasal and Oral Vaccinations

While most vaccines are administered by either intramuscular or subcutaneous injection, there are several vaccines that are administered through other means. These include the intradermal route, the intranasal route, and the oral route. Here are some simple instructions to use as a guide. Complete information is available in the package inserts and can also be obtained at www.immunize.org/fda.

Nasal spray: Influenza vaccine

■ *FluMist by AstraZeneca, Live Attenuated Influenza Vaccine (LAIV)*

Instructions for administration by a healthcare provider in a healthcare setting:

- 1 FluMist (LAIV) is for intranasal administration only. Do not inject FluMist.
- 2 Remove the rubber tip protector. Do not remove the dose-divider clip at the other end of the sprayer.
- 3 With the patient in an upright position, place the tip just inside the nostril to ensure LAIV is delivered into the nose. The patient should breathe normally.
- 4 With a single motion, depress the plunger as rapidly as possible until the dose-divider clip prevents you from going further.
- 5 Pinch and remove the dose-divider clip from the plunger.
- 6 Place the tip just inside the other nostril, and with a single motion, depress plunger as rapidly as possible to deliver the remaining vaccine.
- 7 Dispose of the sprayer according to the standard procedures for medical waste (such as in a sharps container or biohazard container).

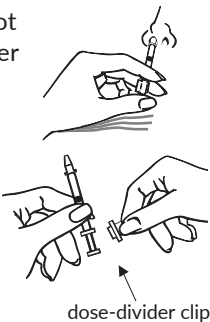

Oral drops: Rotavirus vaccines

■ *Rotarix by GSK – available in two presentations:*
(a) a vial and oral dosing applicator (requires reconstitution) and
(b) a fully liquid oral dosing applicator only.

If using the fully liquid presentation,

- 1 Remove the cap from the oral dosing applicator.
- 2 Follow steps 6 and 7 below.

If using vial and oral dosing applicator (requires reconstitution),

- 1 Remove the cap of the vial and push the transfer adapter onto the vial (lyophilized vaccine).
- 2 Shake the diluent in the oral applicator (white, turbid suspension). Connect the oral applicator to the transfer adapter.
- 3 Push the plunger of the oral applicator to transfer the diluent into the vial. The suspension will appear white and cloudy.
- 4 Withdraw the vaccine into the oral applicator.
- 5 Twist and remove the oral applicator from the vial.
- 6 Administer the dose by gently placing the applicator plunger into the infant's mouth toward the inner cheek and gently expelling the contents until the applicator is empty.
- 7 Discard the empty vial (if lyophilized vaccine was used), cap, and oral applicator in an approved biological waste container according to local regulations.

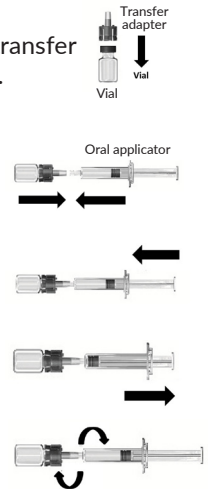

■ *Rotateq by Merck*

- 1 Tear open the pouch and remove the dosing tube. Clear the fluid from the dispensing tip by holding the tube vertically and tapping the cap.
- 2 Open the dosing tube in two easy motions:
 - a) Puncture the dispensing tip by screwing cap **clockwise** until it becomes tight.
 - b) Remove the cap by turning it **counter-clockwise**.
- 3 Administer the dose by gently squeezing liquid into infant's mouth toward the inner cheek until dosing tube is empty. (A residual drop may remain in the tip of the tube.)
- 4 Discard the empty tube and cap in an approved biological waste container according to local regulations.

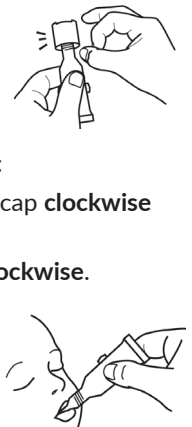

Note: If, for any reason, an incomplete dose is administered (e.g., infant spits or regurgitates the vaccine), a replacement dose is not recommended.

